

Ring Terminal - insulated  
 Part No: FVL2216-5R2

STUD SIZE #10

SYM.	CHANGES	BY	DATE

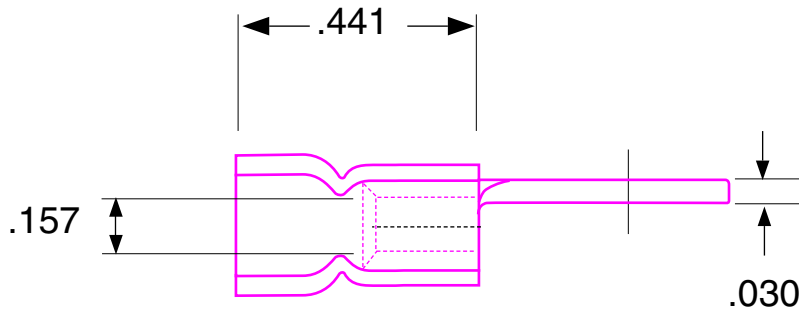
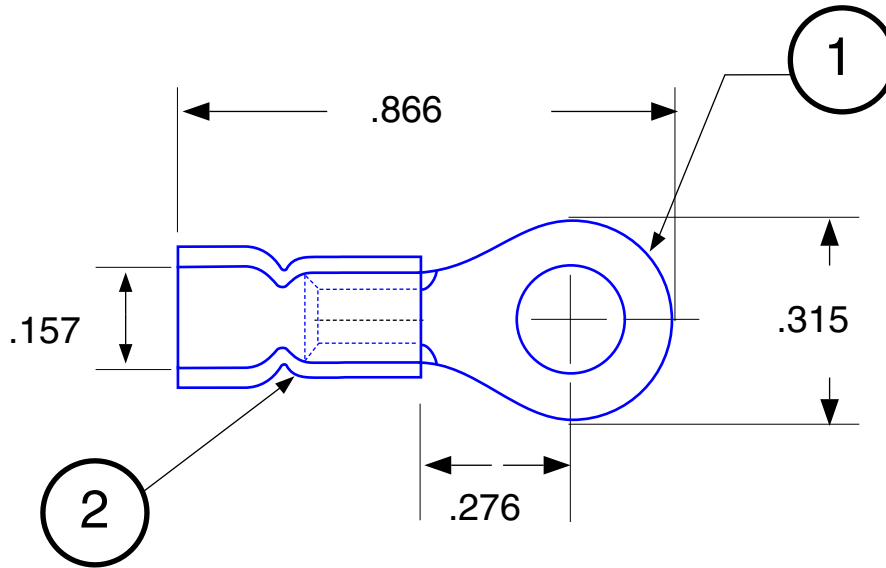

Max Electric Current: 22-16 AWG : 19 Amp  
 Max Electric Rating: 75° C / 600 V Max  
 Tolerance ±.020



**HOFFMAN PRODUCTS**

20700 Hubbell Avenue, Oak Park, MI 48237  
 Tel: 1-800-645-2014 • Fax: 1-800-908-1295  
 Web: www.hoffmanproducts.com

NO.	1	2	3
NAME	TERMINAL	INSULATOR	FUNNEL ENTRY
MAT'L. / SPEC	COPPER	VINYL	
REMARKS	TIN-PLATED	RED	
APPROVED BY:	CHECKED BY:	DRAWN BY:	

DATE:	TITLE: Ring Terminal Vinyl Insulated		
SCALE: FREE	PART NO. FVL2216-5R2		
DRAWING NO. H1506	PART NAME		ISSUE

HOFFMAN CADFILE