



ALL RIGHTS RESERVED. NO PORTION OF THIS PUBLICATION, WHETHER IN WHOLE OR IN PART CAN BE REPRODUCED WITHOUT THE EXPRESS WRITTEN CONSENT OF SPC TECHNOLOGY.

SPC-F005.DWG

REVISIONS

DOC. NO. SPC-F005 * Effective: 7/8/02 * DCP No: 1398

DCP #	REV	DESCRIPTION	DRAWN	DATE	CHECKD	DATE	APPRVD	DATE
1908	A	RELEASED	JN	10/22/09	JN	10/22/09	JN	10/22/09

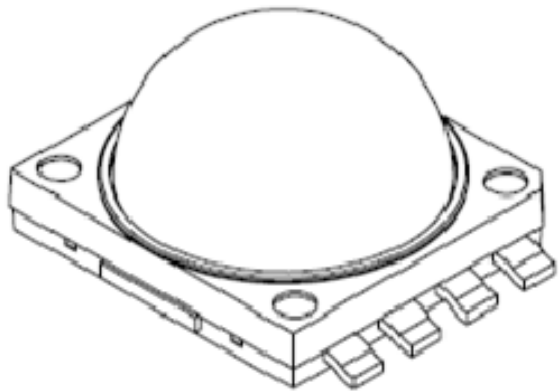

HEATSINK

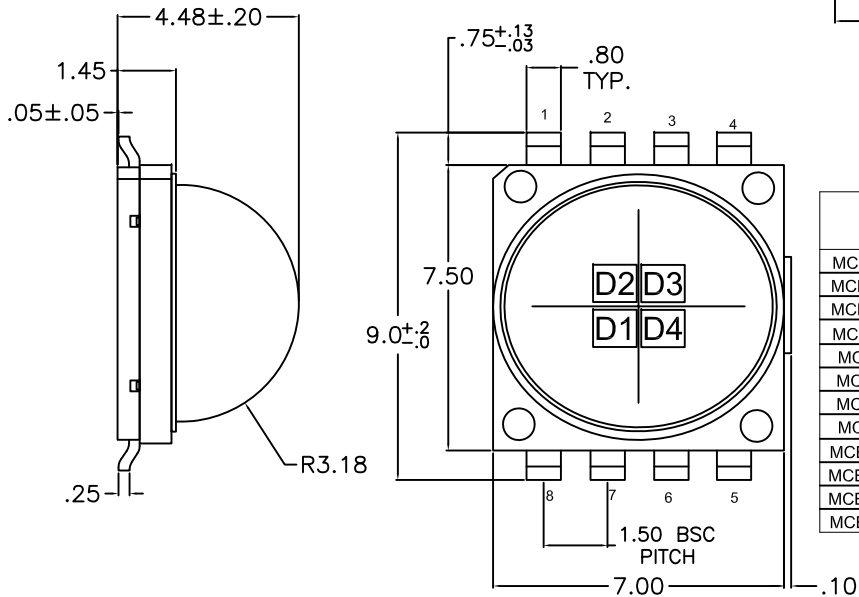
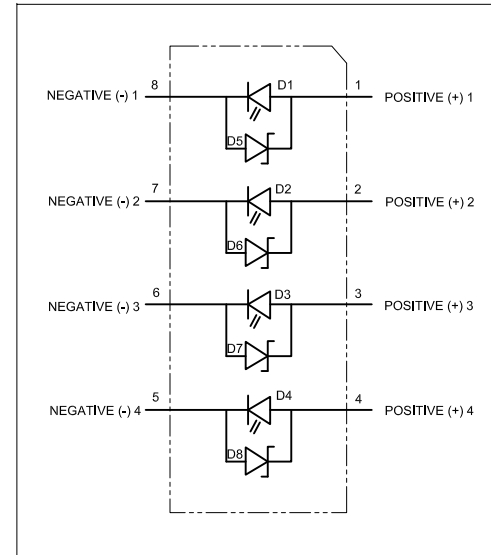
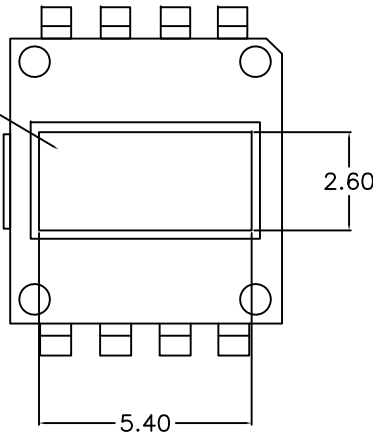

PART NO.	BRD	Circuit	BRD Thickness	LED Color	LED Color bins	LED Flux Code	LED Lumen (mln.)	each LED VF (typ.) @350mA	LED Viewing Angle	
MCE4WT-A2-0000-00K02-STARSR	star	Series (Figure 1)	2mm	cool white	WC,WD,WG,WF	K	370lm	3.2V	110deg	
MCE4WT-A2-0000-00M02-STARSR			2mm	cool white	WC,WD,WG,WF	M	430lm			
MCE4WT-A2-0000-00KE4-STARSR			2mm	neutral white	4A,4B,4C,4D	K	370lm			
MCE4WT-A2-0000-00JF7-STARSR			2mm	warm white	7A,7B,7C,7D	J	320lm			
MCE4WT-A2-0000-00K02-STARP		Parallel (Figure 2)	Parallel (Figure 2)	2mm	cool white	WC,WD,WG,WF	K			370lm
MCE4WT-A2-0000-00M02-STARP				2mm	cool white	WC,WD,WG,WF	M			430lm
MCE4WT-A2-0000-00KE4-STARP				2mm	neutral white	4A,4B,4C,4D	K			370lm
MCE4WT-A2-0000-00JF7-STARP				2mm	warm white	7A,7B,7C,7D	J			320lm
MCE4WT-A2-0000-00K02-STARIND		Individual (Figure 3)	Individual (Figure 3)	2mm	cool white	WC,WD,WG,WF	K			370lm
MCE4WT-A2-0000-00M02-STARIND				2mm	cool white	WC,WD,WG,WF	M			430lm
MCE4WT-A2-0000-00KE4-STARIND				2mm	neutral white	4A,4B,4C,4D	K			370lm
MCE4WT-A2-0000-00JF7-STARIND				2mm	warm white	7A,7B,7C,7D	J			320lm

DISCLAIMER:
ALL STATEMENTS AND TECHNICAL INFORMATION CONTAINED HEREIN ARE BASED UPON INFORMATION AND/OR TESTS WE BELIEVE TO BE ACCURATE AND RELIABLE. SINCE CONDITIONS OF USE ARE BEYOND OUR CONTROL, THE USER SHALL DETERMINE THE SUITABILITY OF THE PRODUCT FOR THE INTENDED USE AND ASSUME ALL RISK AND LIABILITY WHATSOEVER IN CONNECTION THEREWITH.

TOLERANCES:
UNLESS OTHERWISE SPECIFIED, DIMENSIONS ARE FOR REFERENCE PURPOSES ONLY.

DRAWN BY: Jason Nash
DATE: 10/22/09
CHECKED BY: Jason Nash
DATE: 10/22/09
APPROVED BY: Jason Nash
DATE: 10/22/09

DRAWING TITLE: Emitter Boards utilizing Cree's MCE LEDs

SIZE: A	DWG. NO.: Ta-1202	ELECTRONIC FILE: Ta-1202.dwg	REV: A
SCALE: NTS		U.O.M.: mm [INCHES]	SHEET: 1 OF 2

Figure 1

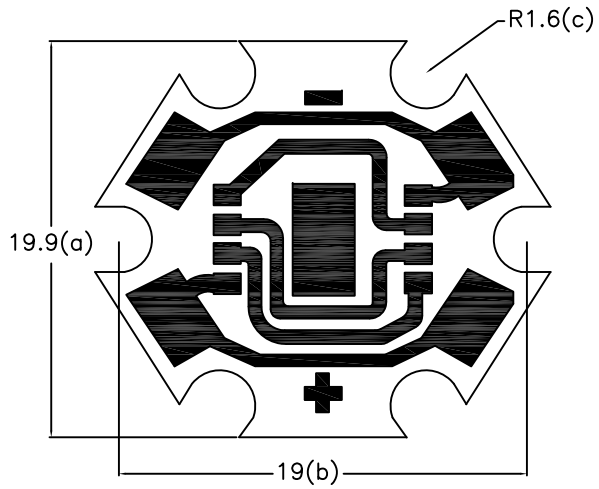

STAR MCPCB in series
White mask Gold letter

Figure 2

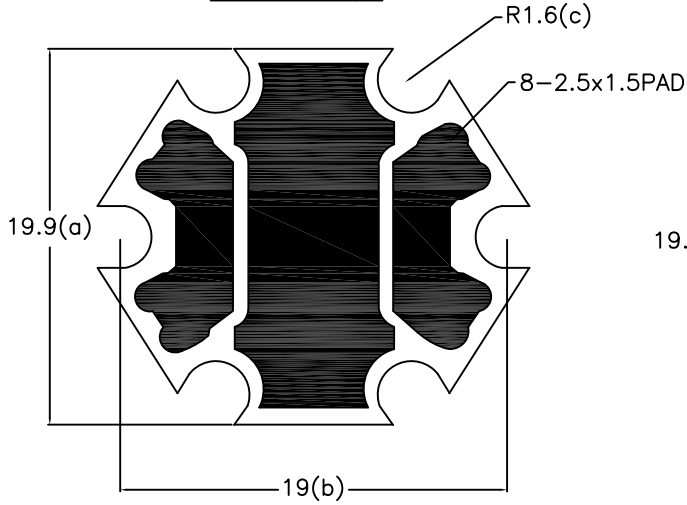

STAR MCPCB in parallel
White mask Gold letter

Figure 3

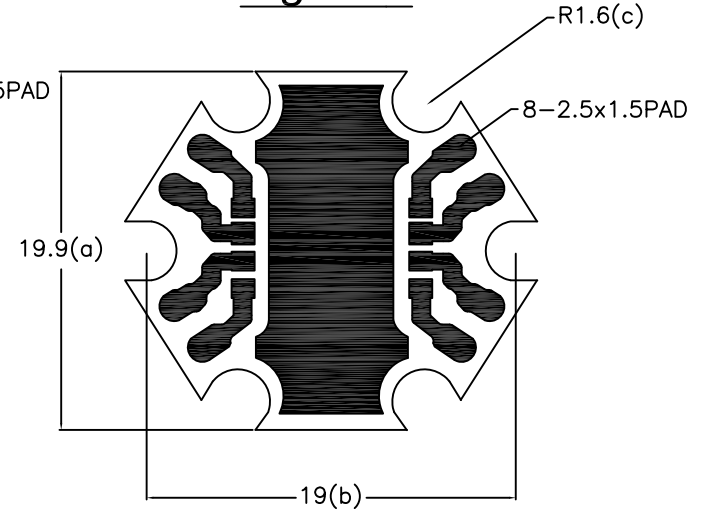

STAR MCPCB in individual
White mask Gold letter

ALL RIGHTS RESERVED. NO PORTION OF THIS PUBLICATION, WHETHER IN WHOLE OR IN PART CAN BE REPRODUCED WITHOUT THE EXPRESS WRITTEN CONSENT OF SPC TECHNOLOGY.

SIZE A	DWG. NO. Ta-1202	ELECTRONIC FILE Ta-1202	REV
SCALE: NTS	U.O.M.: Millimeters	SHEET: 2 OF 2	