



ALL RIGHTS RESERVED. NO PORTION OF THIS PUBLICATION, WHETHER IN WHOLE OR IN PART CAN BE REPRODUCED WITHOUT THE EXPRESS WRITTEN CONSENT OF SPC TECHNOLOGY.

SPC-F005.DWG

## REVISIONS

DOC. NO. SPC-F005 \* Effective: 7/8/02 \* DCP No: 1398

DCP #	REV	DESCRIPTION	DRAWN	DATE	CHECKD	DATE	APPRVD	DATE
1501	A	RELEASED	JWM	10/13/03	HO	10/17/03	DJC	10/17/03

## SPECIFICATIONS

### ELECTRICAL

CONTACT RATING: 5A @ 120 VAC OR  
28 VDC, 2A @ 250 VAC

CONTACT RESISTANCE: 10 MILLIOHMS MAX.

INSULATION RESISTANCE: 1,000 MEGOHMS MIN. AT 500 VDC

DIELECTRIC STRENGTH: 1,000 VRMS

### MECHANICAL

LIFE: 30,000 CYCLES

### ENVIRONMENTAL

OPERATING TEMPERATURE: -30°C TO +85°C

### MATERIAL

CASE: DAP, UL 94V-0

HOUSING: STAINLESS STEEL

ACTUATOR: NYLON, BLACK

CONTACT/TERMINALS: COPPER ALLOY, SILVER PLATED

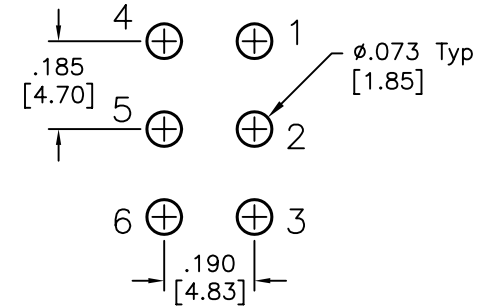
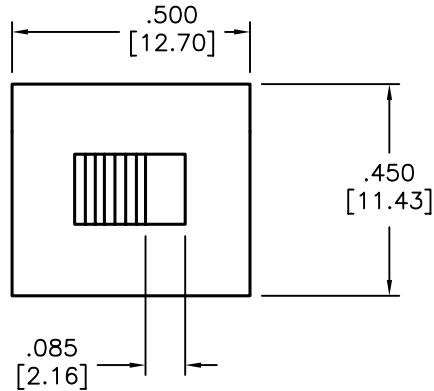

PCB LAYOUT

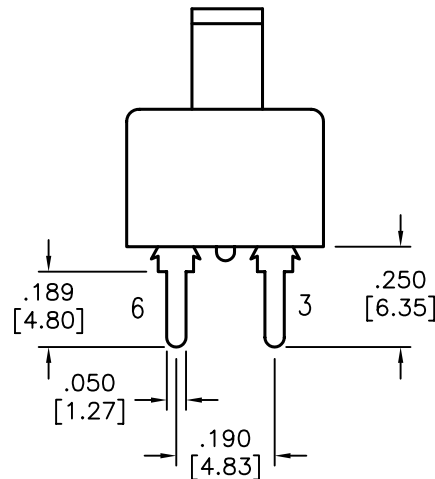
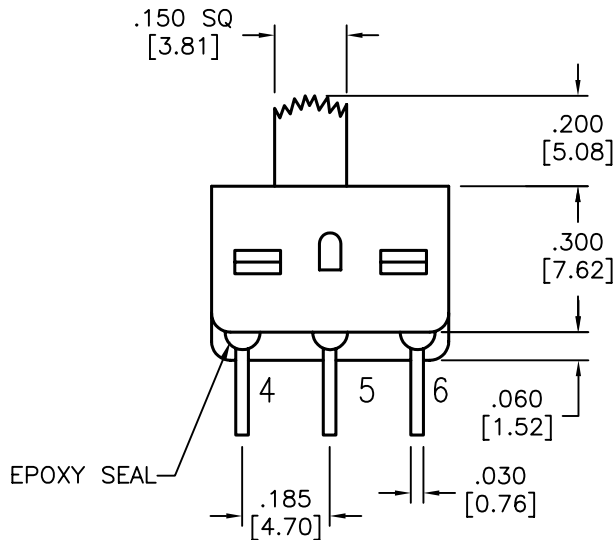

	SWITCHING FUNCTION		
	ON	NONE	ON
CONN. TERMS	2-1 5-4	OPEN	2-3 5-6
SCHEMATIC SHORTING TYPE	DPDT		

DISCLAIMER:  
ALL STATEMENTS AND TECHNICAL INFORMATION CONTAINED HEREIN ARE BASED UPON INFORMATION AND/OR TESTS WE BELIEVE TO BE ACCURATE AND RELIABLE. SINCE CONDITIONS OF USE ARE BEYOND OUR CONTROL, THE USER SHALL DETERMINE THE SUITABILITY OF THE PRODUCT FOR THE INTENDED USE AND ASSUME ALL RISK AND LIABILITY WHATSOEVER IN CONNECTION THEREWITH.

### TOLERANCES:

UNLESS OTHERWISE SPECIFIED, DIMENSIONS ARE FOR REFERENCE PURPOSES ONLY.

### DRAWN BY:

Jeff McVicker

### DATE:

10/13/03

### CHECKED BY:

Hisham Odish

### DATE:

10/17/03

### APPROVED BY:

Daniel Carey

### DATE:

10/17/03

### DRAWING TITLE:

Slide Switch, DPDT, PCB Mount

### SIZE

A

### DWG. NO.

SPC12419

### ELECTRONIC FILE

53H6678.dwg

### REV

A

SCALE: NTS

U.O.M.: INCHES [mm]

SHEET: 1 OF 1